

# Submittal Data

# 60 Cycle



JOB or CUSTOMER: \_\_\_\_\_

ENGINEER: \_\_\_\_\_

CONTRACTOR: \_\_\_\_\_

SUBMITTED BY: \_\_\_\_\_ DATE: \_\_\_\_\_

APPROVED BY: \_\_\_\_\_ DATE: \_\_\_\_\_

ORDER NO: \_\_\_\_\_ DATE: \_\_\_\_\_

SPECIFICATION REF: \_\_\_\_\_

QUANTITY	TAG NO.	MODEL NO.	GPM	FEET	VOLT	PHASE	COMMENTS

### Technical Data

**FLOW RANGE:** 0 to 46 U.S. GPM      **MIN. FLUID TEMPERATURE for UP15:** 36°F (2°C)  
**HEAD RANGE:** 0 to 32 Feet      **MIN. FLUID TEMPERATURE for ALL OTHERS:** 32°F (0°C)  
**MOTOR:** 2Pole, Single Phase  
**MAXIMUM FLUID TEMPERATURE – CLOSED SYSTEMS:** 230°F (110°C)



Ambient Air Temp.	95°F (35°C)	130°F (55°C)	140°F (60°C)	160°F (71°C)	175°F (79°C)
Maximum Water Temp.	230°F (110°C)	220°F (104°C)	210°F (99°C)	190°F (88°C)	175°F (79°C)

**MAXIMUM WORKING PRESSURE:** 145 PSI  
**MINIMUM REQUIRED INLET PRESSURE:**

230°F (110°C)	190°F (88°C)	140°F (60°C)
36 Ft. (1.10m)	9.0 Ft. (2.8m)	3.0 Ft. (0.9m)
15.6 psi	4.0 psi	1.3 psi

### Mounting Positions

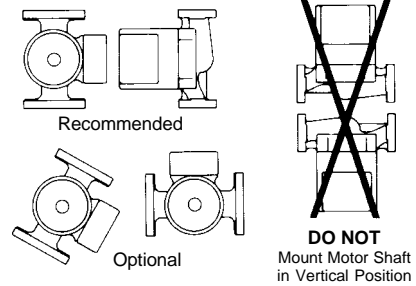

**FOR INDOOR USE ONLY**

### Dimensions, and Weights

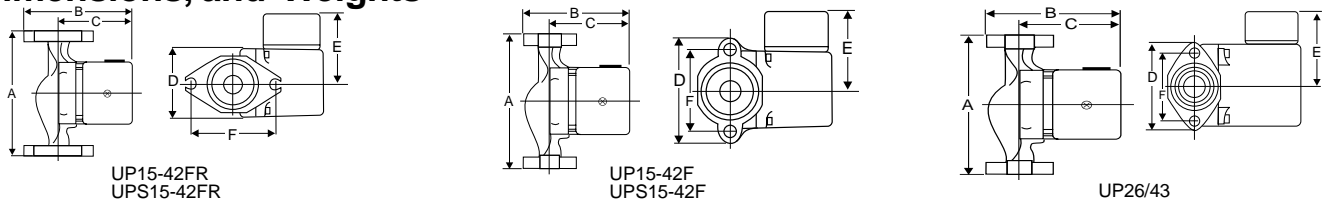

CLOSED SYSTEM MODELS	A	B	C	D	E	F ①	Shipping Connection Type and Size	Wt. (Lbs.)
UP15-42F (BRUTE II®) & UPS15-42F	6 1/2	5 1/4	4	4 3/16	3 1/4	3 5/32	Flange – (2) 1/2" Dia. Bolt Holes	7 1/4
UP15-FR (BRUTE II®) & UPS15-42FR	6 1/2	5 15/16	4	3 3/4	3 1/4	3 5/32	Flange – (2) 1/2" Dia. Bolt Holes	7 1/4
UP15-42FC (*Brute II w/ check valve)	6 1/2	5 1/4	4	4 3/16	3 1/4	3 5/32	Flange – (2) 1/2" Dia. Bolt Holes	7 1/4
UP26-64F & UP26-96F	6 1/2	6 3/8	5 1/16	4 1/8	3 1/2	3 5/32	Flange – (2) 1/2" Dia. Bolt Holes	11 1/4
UP26-99F	6 1/2	6 3/8	5 1/16	4 1/8	3 1/2	3 5/32	Flange – (2) 1/2" Dia. Bolt Holes	12 1/2
UP43-75F	8 1/2	6 11/16	5 3/16	4 3/4	3 1/2	3 7/16	Flange – (2) 1/2" Dia. Bolt Holes	13 1/2

NOTES: All dimensions are in inches. ① "F" dimension is the flange bolt centerline to centerline.  
 \*Circulators w/ check valve have a maximum water temperature of 200°F.

# Performance Curves

Cast Iron Construction – Flange Mount

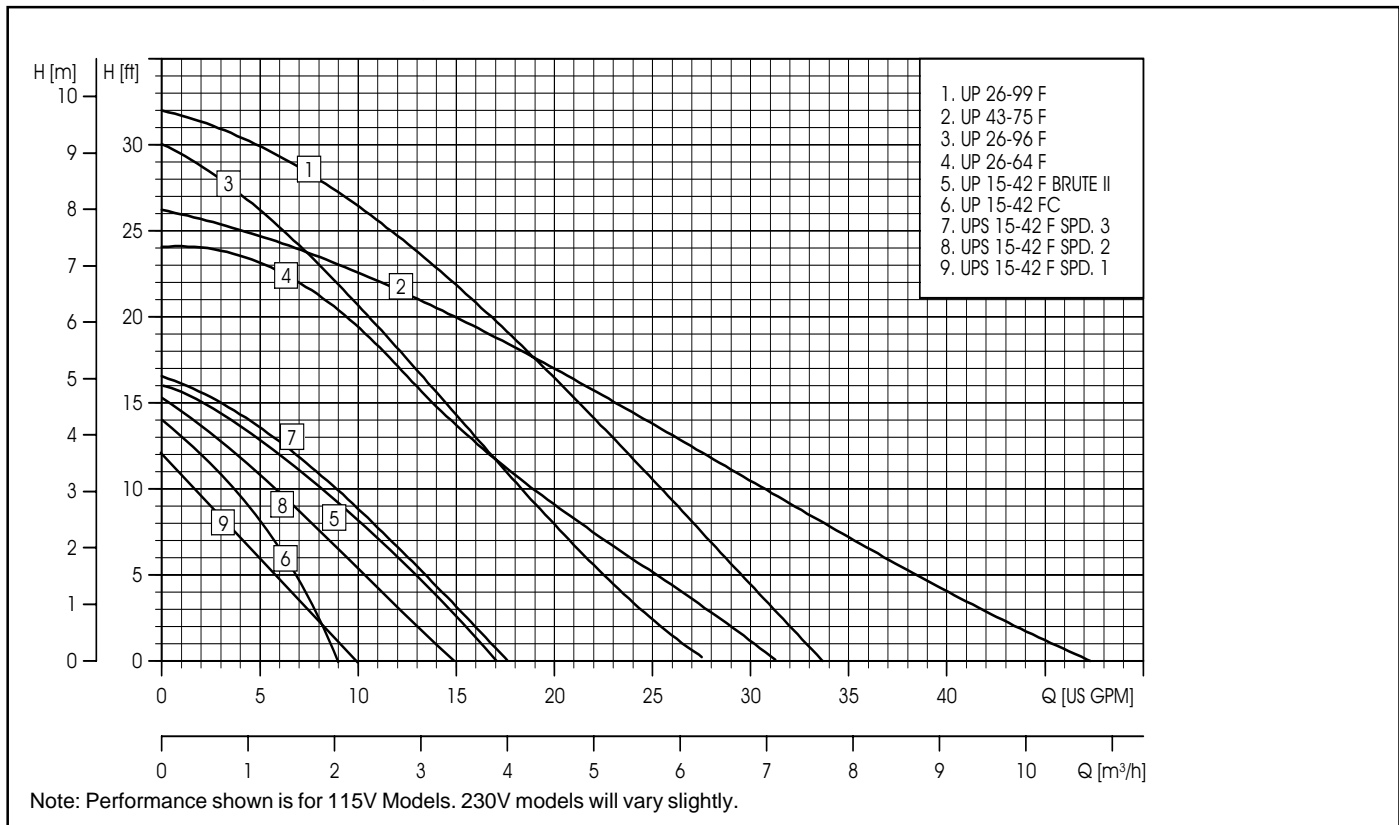

## Electrical Data

MODEL	VOLTS	AMPS	WATTS	HP	CAPACITOR	MODEL	VOLTS	AMPS	WATTS	HP	CAPACITOR
UP15-42F/FR/FC (BRUTE II®)	115	.74	85	1/25	10µF/180V	UP26-64F	115	1.70	185	1/12	8µF/180V
	230	.43	95	1/25	2µF/400V		230	.80	175	1/12	2.5µF/380V
UPS15-42F Spd. 3 (115V)	115	.74	85	1/25	10µF/180V	UP26-96F	115	1.70	205	1/12	10µF/180V
	Spd. 2	---	.57	65	---		230	.80	205	1/12	2.5µF/380V
	Spd. 1	---	.40	45	---	---	UP26-99F	115	2.15	245	1/6
UPS15-42F Spd. 3 (230V)	230	.43	95	1/25	2µF/400V	230		1.07	245	1/6	2.5µF/380V
Spd. 2	---	.19	40	---	---	UP43-75F	115	2.15	215	1/6	10µF/180V
Spd. 1	---	.14	30	---	---		230	1.07	220	1/6	2.5µF/380V

NOTE: All UP models are single speed except for the 3-speed UPS15-42F, 115 and 230 volt.

## Materials of Construction

DESCRIPTION	MATERIAL	DESCRIPTION	MATERIAL
Inlet Cone, Bearing Plate, Bearing Retainers, Rotor Can, Rotor Cladding, Shaft Retainer	304 Stainless Steel	Pump Housing (Volute)	Cast Iron
Stator Housing	Aluminum	O'Ring & Gaskets	EP (Ethylene Propylene Rubber)
Shaft, Upper & Lower Radial Bearings	Aluminum Oxide Ceramic	Impeller	PES Composite (30% Glass Filled)
Thrust Bearing	Metal Impregnated Carbon	Terminal Box	Noryl®
Check Valve	ACETAL With 302 Stainless Steel Spring & Nitrile Rubber Seats		

NOTE: Noryl® is a registered trademark of General Electric Company. BRUTE II® is a registered trademark of Grundfos Pumps Corporation.



Leaders in Pump Technology

Grundfos Pumps Corporation • 3131 N. Business Park Avenue • Fresno, CA 93727  
Customer Service Centers: Allentown, PA • Fresno, CA



Phone: (800) 333-1366 • Fax: (800) 333-1363  
Canada: Oakville, Ontario • Mexico: Apodaca, N.L.

Visit our website at [www.us.grundfos.com](http://www.us.grundfos.com)

L-UP-TL-107 Rev. 12/00  
PRINTED IN USA