

Wet-Rotor, In-Line, Single Stage, Maintenance Free, Circulator Pumps

Submittal Data

60 Cycle

	JOB or CUSTOMER:	
	ENGINEER:	
	CONTRACTOR:	
	SUBMITTED BY:	DATE:
	APPROVED BY:	DATE:
	ORDER NO:	DATE:
	SPECIFICATION REF:	

QUANTITY	TAG NO.	MODEL NO.	GPM	FEET	VOLT	PHASE	COMMENTS

Technical Data

FLOW RANGE: 0 to 46 U.S. GPM **MIN. FLUID TEMPERATURE for UP15:** 36°F (2°C)
HEAD RANGE: 0 to 32 Feet **MIN. FLUID TEMPERATURE for ALL OTHERS:** 32°F (0°C)
MOTORS: 2 Pole, Single Phase
MAXIMUM FLUID TEMPERATURE: 220°F (104°C), Maximum design temperature.
FOR OPEN SYSTEMS - 140°F (60°C) is the maximum recommended fluid temperature to avoid precipitation of calcium in water.



Ambient Air Temp.	130°F (55°C)	140°F (60°C)	160°F (71°C)	175°F (79°C)
Maximum Water Temp.	220°F (104°C)	210°F (99°C)	190°F (88°C)	175°F (79°C)

MAXIMUM WORKING PRESSURE: 145 PSI

MINIMUM REQUIRED INLET PRESSURE:

Temperature	220°F (104°C)	190°F (88°C)	140°F (60°C)
Pressure	36 Ft. (11m) 15.6 psi	9.0 Ft. (2.8m) 4.0 psi	3.0 Ft. (0.9m) 1.3 psi

Mounting Positions

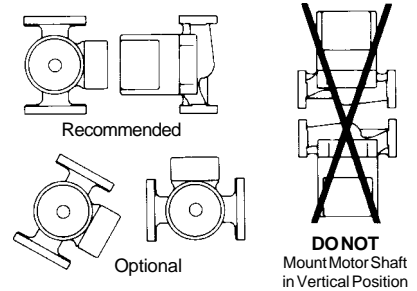

FOR INDOOR USE ONLY

Dimensions, and Weights

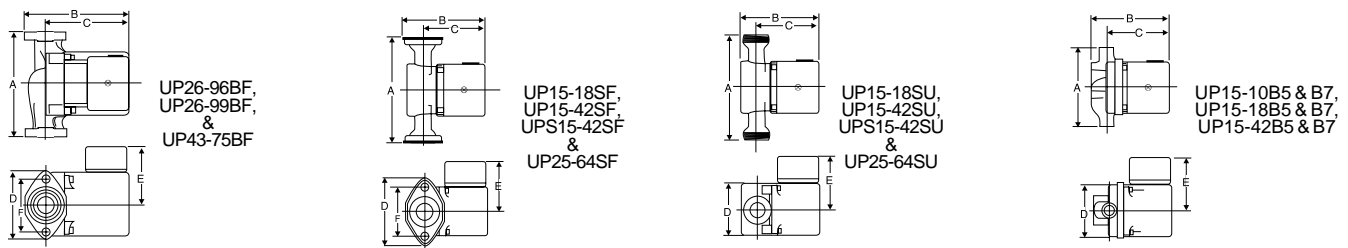

OPEN SYSTEM MODELS	A	B	C	D	E	F ①	Connection Type and Size	Shipping Wt. (Lbs.)
UP15-10B5	5	4 11/16	4	4	3 1/2	—	Sweat – 1/2"	6
UP15-10B7	6 3/8	5 1/8	4	3 13/16	3 1/4	—	Sweat – 3/4"	6.7
UP15-18SU & UP/UPS15-42SU	5 7/8	5 1/16	4	3 7/16	3 1/4	—	Union – 1 1/4" NPSM	5
UP15-18SF & UP/UPS15-42SF	6 1/2	5 1/4	4	4 3/16	3 1/4	3 5/32	Flange – (2) 1/2" Dia. Bolt Holes	6
UP15-18B5 & UP15-42B5	5	4 11/16	4	3 1/2	3 1/4	—	Sweat – 1/2"	6
UP15-18B7 & UP15-42B7	6 3/8	5 1/8	4	3 13/16	3 1/4	—	Sweat – 3/4"	6.7
UP25-64SU	5 7/8	5 13/16	4 13/16	4	3 1/2	—	Union – 1 1/4" NPSM	9
UP25-64SF	6 1/2	6 1/16	4 13/16	4 3/16	3 1/2	3 5/32	Flange – (2) 1/2" Dia. Bolt Holes	10
UP26-96BF	6 1/2	6 3/8	5 1/16	4 1/8	3 1/2	3 5/32	Flange – (2) 1/2" Dia. Bolt Holes	12.5
UP26-99BF	6 1/2	6 3/8	5 1/16	4 1/8	3 1/2	3 5/32	Flange – (2) 1/2" Dia. Bolt Holes	12.5
UP43-75BF	8 1/2	6 11/16	5 3/16	4 3/4	3 1/2	3 7/16	Flange – (2) 1/2" Dia. Bolt Holes	15

NOTES: All dimensions are in inches. ① "F" dimension is the flange bolt centerline to centerline.

Performance *Stainless Steel or Bronze Construction - Flange, Union, or Sweat Mount*

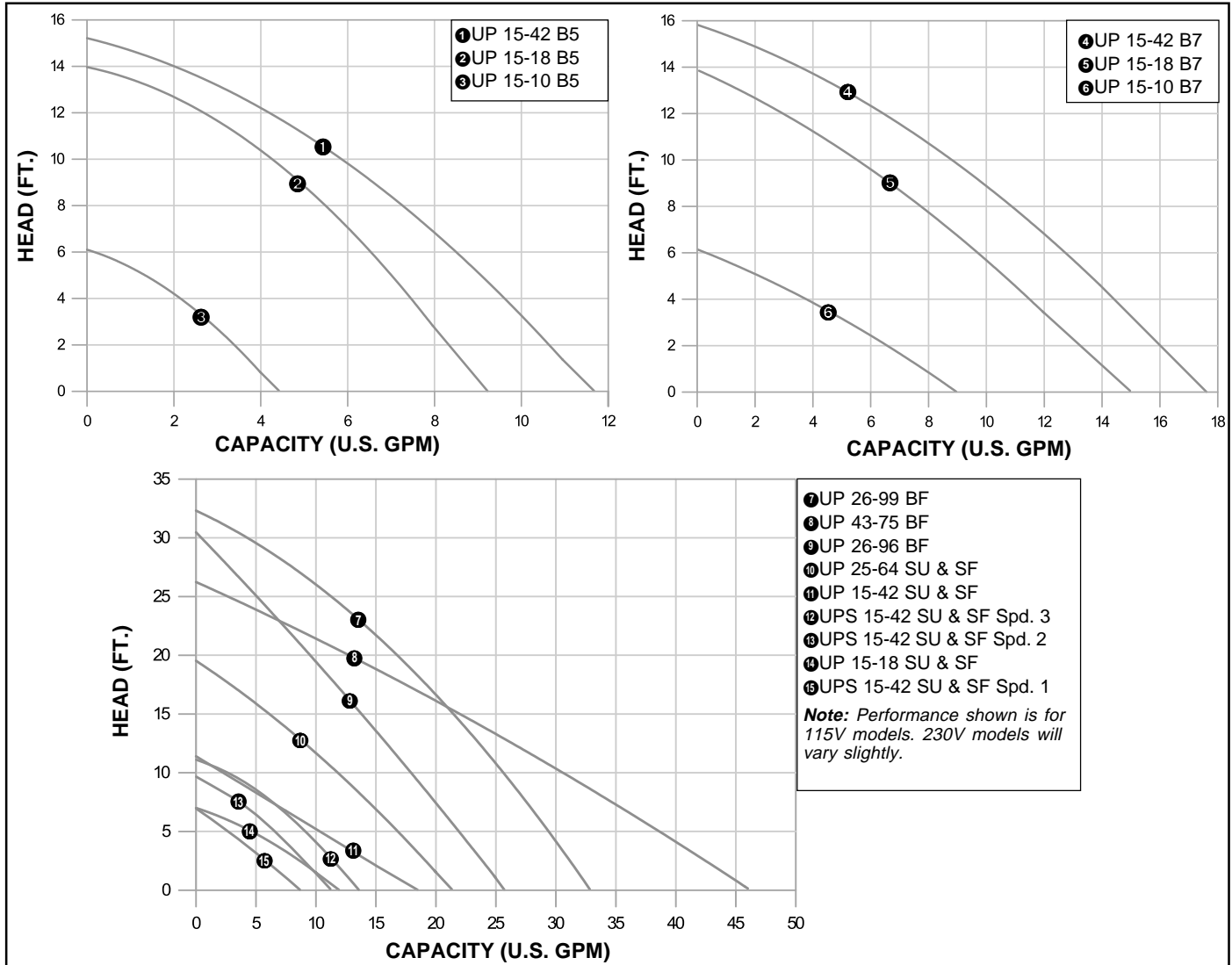

Electrical Data

MODEL	VOLTS	AMPS	WATTS	HP	CAPACITOR	MODEL	VOLTS	AMPS	WATTS	HP	CAPACITOR
UP15-10B5 & B7	115	.55	58	1/25	8μF/180V	UP25-64SU & SF	115	1.70	180	1/12	8μF/180V
UP15-18SU, SF, & B5	115	.74	85	1/25	10μF/180V		230	.80	175	1/12	2.5μF/380V
UP15-18B7	115	.74	85	1/25	10μF/180V	UP26-96BF	115	1.70	205	1/12	10μF/180V
	230	.40	90	1/25	2μF/400V		230	.80	205	1/12	2.5μF/380V
UP15-42SU, SF, & B5	115	.74	85	1/25	10μF/180V	UP26-99BF	115	2.15	245	1/6	10μF/180V
	230	.41	95	1/25	2μF/400V		230	1.07	245	1/6	2.5μF/380V
UP15-42B7	115	.74	85	1/25	10μF/180V	UP43-75BF	115	2.15	215	1/6	10μF/180V
	230	.41	95	1/25	2μF/400V		230	1.07	220	1/6	2.5μF/380V

Materials of Construction

DESCRIPTION	MATERIAL	DESCRIPTION	MATERIAL
Inlet Cone, Bearing Plate, Bearing Retainers, Rotor Can, Rotor Cladding, Shaft Retainer.	304 Stainless Steel	O'Ring & Gaskets	EP (Ethylene Propylene Rubber)
Volute Retainer (SU & SF Models) & Stator Housing	Aluminum	Pump Housing (Volute)	Silicone Bronze C875 or Stainless Steel
Shaft, Upper & Lower Radial Bearings	Aluminum Oxide Ceramic	Impeller	PES Composite (30% Glass Filled)
Thrust Bearing	Metal Impregnated Carbon	Terminal Box	Noryl®



Leaders in Pump Technology

Grundfos Pumps Corporation • 3131 N. Business Park Avenue • Fresno, CA 93727

Customer Service Centers: Allentown, PA • Fresno, CA

Phone: (800) 333-1366 • Fax: (800) 333-1363

Canada: Oakville, Ontario • Mexico: Apodaca, N.L.

Visit our website at www.us.grundfos.com



L-UP-TL-007 Rev. 01/01
PRINTED IN USA